

1
QG-0169-AI-100016
 Used on
NPS-X-28B

DO NOT SCALE DRAWING

STANDARD CABLE TERMINATES IN A 15 WAY "D" TYPE CONNECTOR
 MIN. BEND RADIUS 14mm

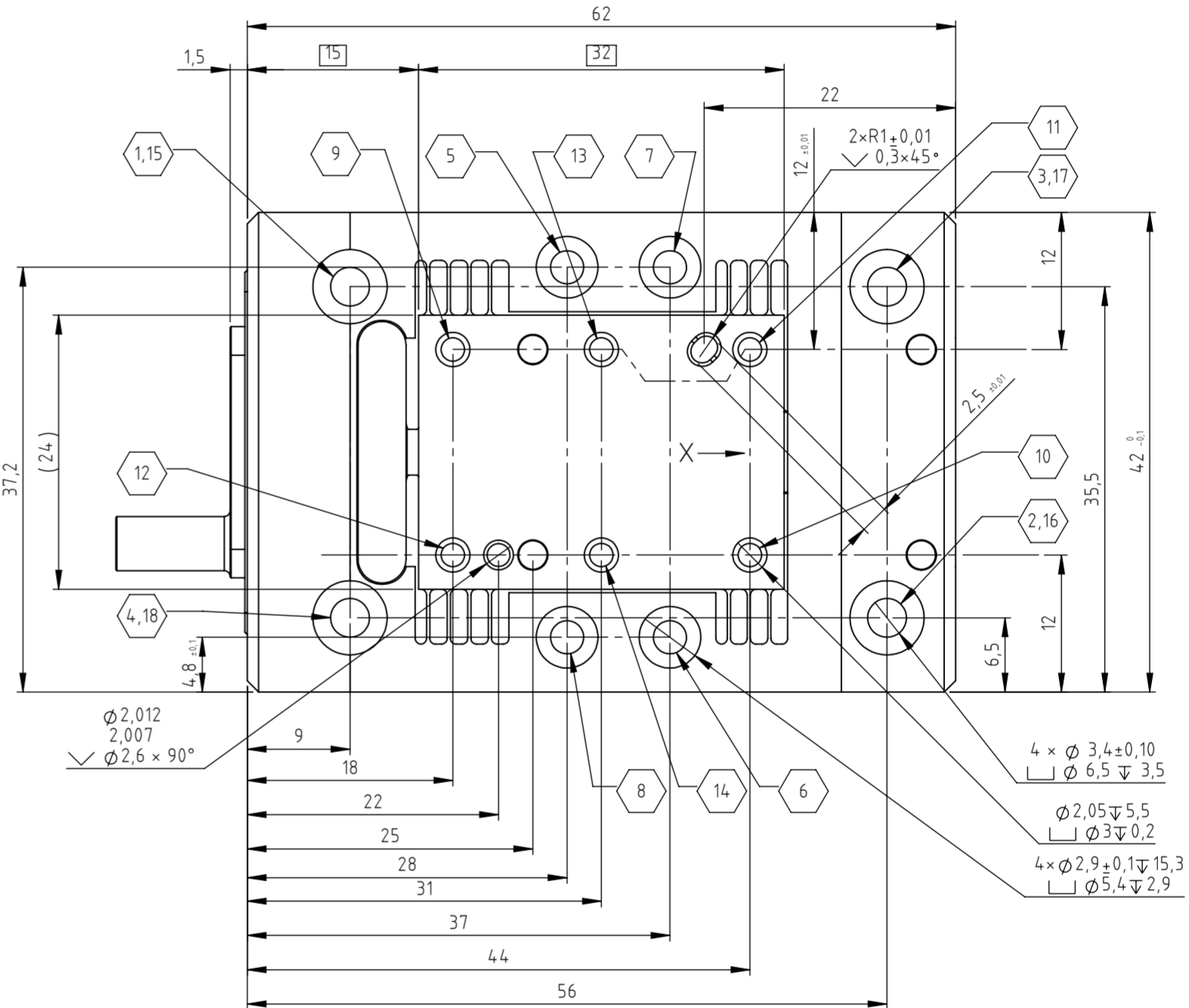
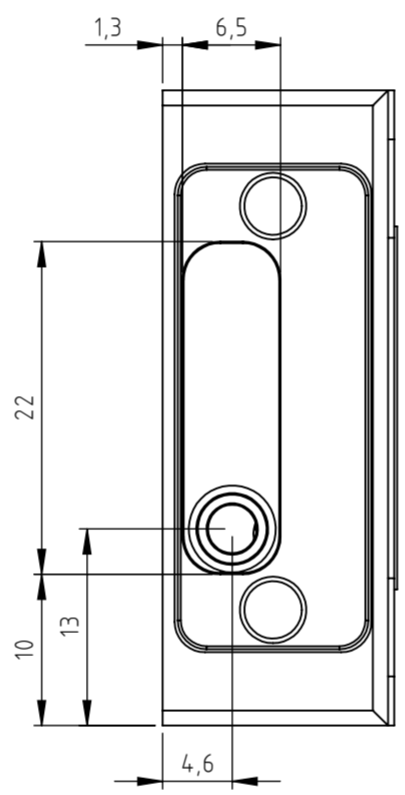
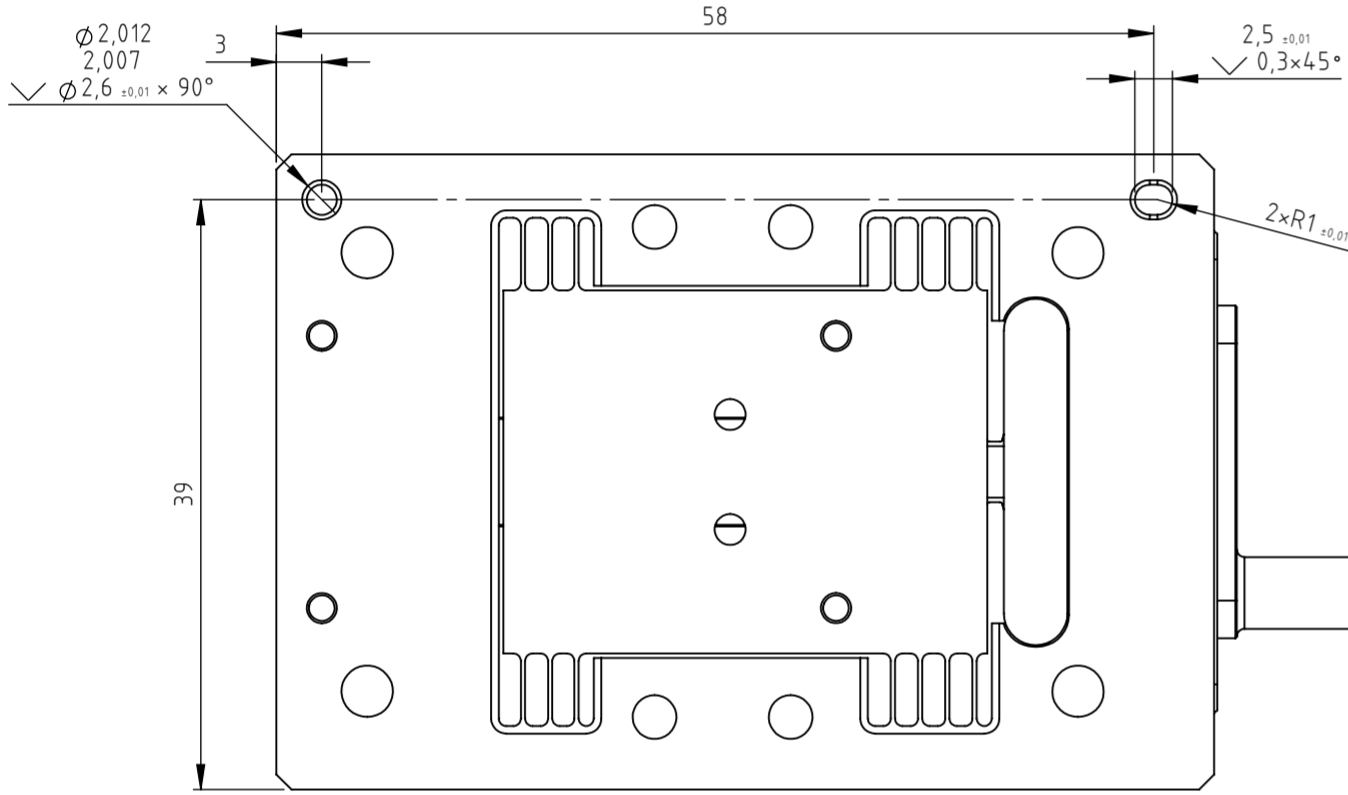

Important notes: Load mounting screws (9-14) should be M2.5 - 6H with a maximum depth of 2.5 mm to avoid collision with stage internals.
 All 8 stage mounting screws (4x M3 & 4x M2.5 must be used and tighten in accordance with the below sequence to ensure specified stage performance.

NOTES:

- ENSURE MOUNTING SURFACES OF PLATFORM & BASE ARE FREE FROM BURRS, DEBRIS ETC. AND ARE FLAT TO 5µm
- SCREW TIGHTENING SEQUENCE:

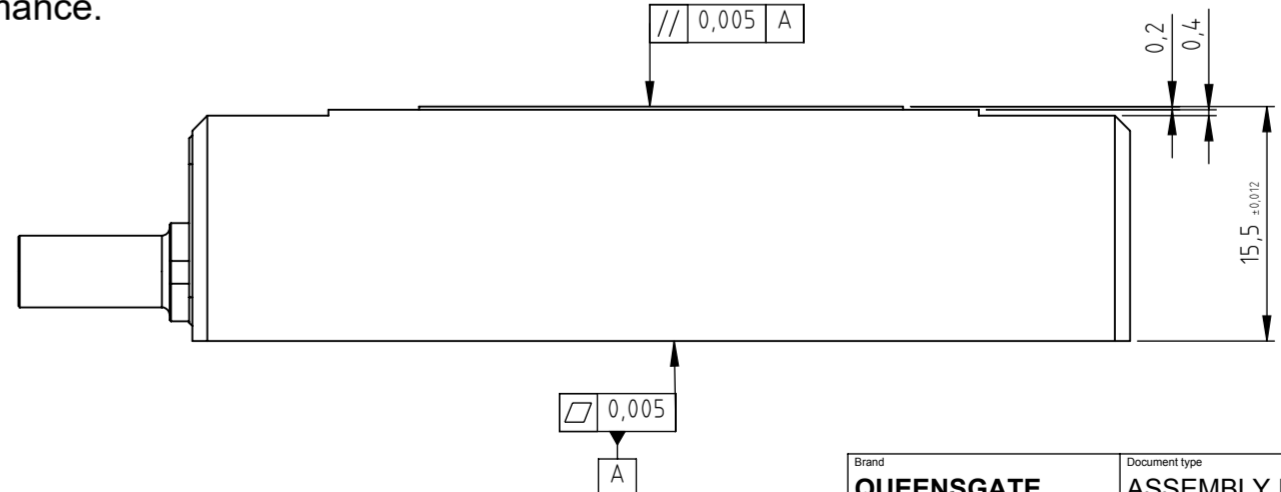
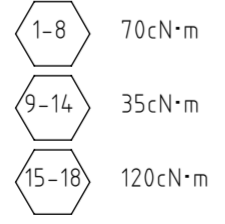

1	RELEASE	27/10/2017
B	TORQUE SETTINGS & SEQUENCE REVISED	08/11/2016
A	FIRST ISSUE	28/09/2016
ISSUE	ECR No.	NOTE
		DATE

**UNCONTROLLED COPY!
 DO NOT PRINT AND STORE!**

Brand QUEENSGATE	Document type ASSEMBLY INSTRUCTION	Date issue created 22-Aug-2017
elektron technology Elektron Technology UK Ltd Broers Building JJ Thomson Avenue Cambridge CB3 0FA United Kingdom www.elektron-technology.com	Drawing no. QG-0169-AI-100016	Material SEE PART DRAWING
	Title / Description NPS-X-28B INSTALLATION INSTRUCTIONS	Finish SEE PART DRAWING
Created by JAbbott	Approved by JClarke	Scale 1:1
	Sheet size A2	Sheet no. Sheet 1 OF 1