

UPRIGHT ORIENTATION SHOWN

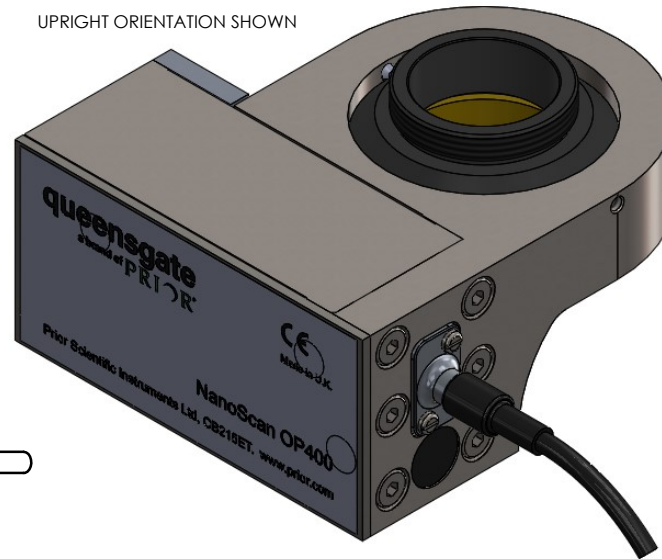

**ADAPTERS AND ACCESSORIES**  
 (SOLD SEPARATELY NOT SHOWN TO SCALE)



MICROSCOPE THREAD MOUNT. SELECT THREAD TO MATCH MICROSCOPE RMS, M25, W26, M27 OR M32.



OBJECTIVE THREAD ADAPTER. SELECT APPROPRIATE THREAD TO MATCH OBJECTIVE RMS, M25, W26 OR M27. NOT REQUIRED FOR M32 SYSTEMS.



PARAFOCAL SPACERS FOR MOVING OTHER OBJECTIVES IN MICROSCOPE NOSE TO THE SAME FOCAL HEIGHT RMS, M25, W26, M27 OR M32. 13mm LONG EXCEPT M32 WHICH IS 12mm.

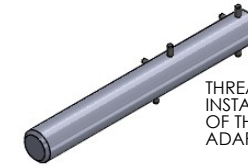

THREAD ADAPTER KEY CAN AID INSTALLATION AND REMOVAL OF THREAD ADAPTERS LIGHTLY NIP UP ADAPTERS ON INSTALLATION.

